

# LSQ<sup>2</sup> + plus



## 2 + F 2 plus

2 Bed + Flex | 2 Bath

Interior: 965 sq. ft.

Exterior: 122 sq. ft.

Total: 1,088 sq. ft.

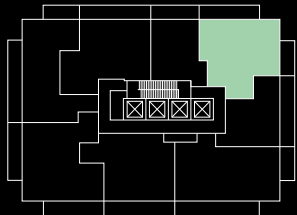

Level 28-29

## almadev

This plan is not to scale and is subject to architectural review and revision. Floor plans are intended to give a general indication of the proposed layout only. All images and dimensions are not intended to form any part of a contract or warranty. The number of units per floor and the number of floors may be reduced or increased at the vendor's sole discretion without notice. The purchaser acknowledges and accepts that the actual unit purchased may be a reverse layout to the plan shown. All materials, specifications, details and dimensions, if any, are approximate and subject to change without notice in order to comply with building site conditions, and municipal, structural, architectural and/or vendor requirements, and any other requirements by law or regulation. Actual living areas may vary from floor area stated. Floor areas have been measured in accordance with all required and customary guidelines and requirements, including the ONHWPA, and such dimensions, whether used in this Purchase Agreement or in any brochure, sketch, floor plan, or other advertising material, are approximate and may differ from the actual dimensions after the completion of the construction of the Unit. Bulkheads are not shown on this plan and may be located in areas of the Unit as required to provide venting and mechanical systems which may alter ceiling height dimensions provided on plans. Balconies, Terraces and Patios, if any, are exclusive use common elements shown for illustration purposes only and location and size are subject to change without notice. Window location, size and type may vary without notice. The length, width and directional position of the flooring are for illustration purposes only and may vary without notice. E.80.E.